



Find the official site here

## TransAcoustic™ Guitar Series Part 1

In Part 1, we introduce the development concept, intended players, and key features of the TransAcoustic guitar series in a Q&A format.

### What is the TransAcoustic Guitar Series?

#### Q How did the development of the TransAcoustic Guitar begin?



LL-TA, first launched in 2016

#### A Surprisingly, it actually began with a piano, not a guitar.

Research into controlling resonance and spatial sound by vibrating the interior of an acoustic instrument was originally conducted during Yamaha piano development. During that process, a simple but powerful idea emerged: “*Could this technology also be applied to guitars?*”

Inspired by this realization, full-scale development of the TransAcoustic guitars began in 2014, culminating in the launch of the LL-TA in 2016. The goal was not to create a guitar that merely adds effects, but one in **which the instrument itself resonates, delivering an entirely new acoustic experience.**

#### Q What does the name “TransAcoustic” mean?

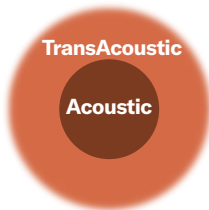

#### A It's a combination of the words “Transcend” and “Acoustic.”

Some people ask whether “Trans-” refers to the transducer (actuator), but that’s not the case. “TransAcoustic” is a coined term derived from **Transcend** and **Acoustic**. The name reflects the developers’ vision of transcending conventional ideas of what an acoustic guitar can be.

#### Q Do you need an amplifier or external speakers?

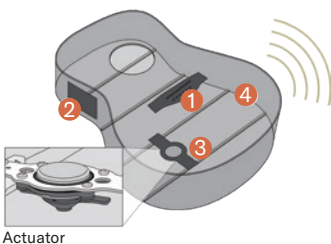

Actuator

#### A No. Thanks to the built-in actuator, effects such as reverb and chorus resonate directly from the body of the guitar itself.

The actuator is a compact vibration device installed inside the guitar. The process works as follows:

- 1 The pickup converts string vibrations into an electrical signal.
- 2 Effects such as reverb or chorus are applied to the signal.
- 3 The actuator converts the processed signal back into physical vibration.
- 4 These vibrations spread through the entire guitar body, producing the effect acoustically.

In other words, the guitar itself becomes the source of the tone.

Players can experience a spacious, room-filling resonance that blends seamlessly with the pure acoustic tone without connecting a single cable to a guitar amp or speaker. This is the defining feature of TransAcoustic technology.

#### Q Is the TransAcoustic Guitar a digital instrument?



#### A No. It is designed specifically for acoustic guitar players.

At first glance, the TransAcoustic guitar may seem focused on digital features. In reality, its design philosophy is quite the opposite. These instruments are designed first and foremost for acoustic guitar players, with the **highest priority placed on authentic tone, natural wood resonance, and traditional aesthetics.** Controls are intentionally straightforward and intuitive, allowing players to shape their tone by simply turning a knob.

From players who enjoy their instrument casually at home to guitarists deeply involved in songwriting and creative work, TransAcoustic guitars are built for anyone seeking the genuine tone and feel of a true acoustic guitar, regardless of their playing style.